

Proposed Project at Premises No-142A, Upendra Nath Banerjee Road, Ward No-131, Borough-XIV, under Kolkata Municipal Corporation, P.S.- Parnashree(Previously Behala), Kolkata-700060

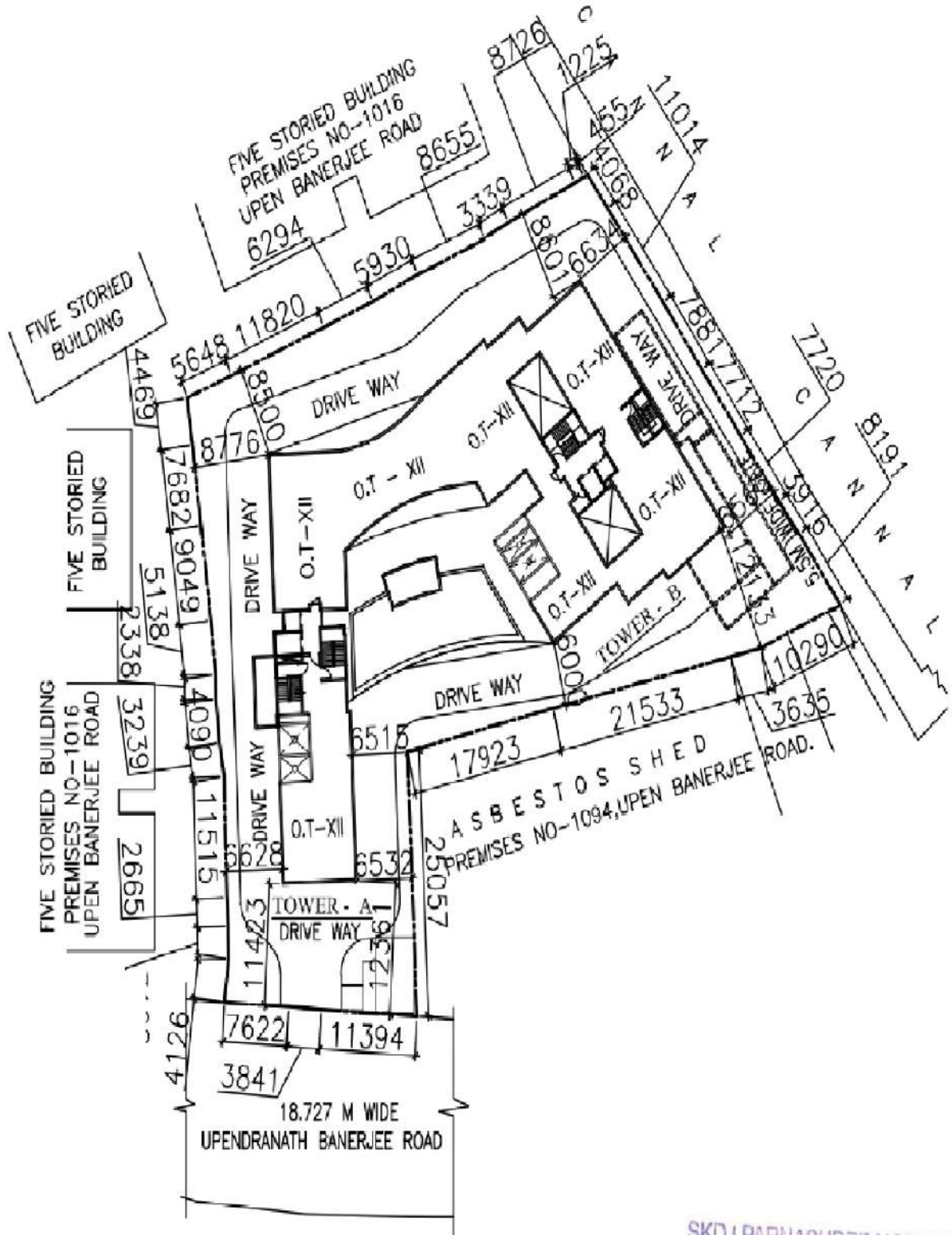

LATITUDE : 22.510707
LONGITUDE : 88.302390

SKDJ PARNASHREE HOME LLP
[Signature]
 Designated Partner

SIGNATURE OF OWNER